

**TOP VIEW**

**PERSPECTIVE VIEW**

DO NOT SCALE

**BAFFLE**

BAFFLE REDUCED WALL THICKNESS

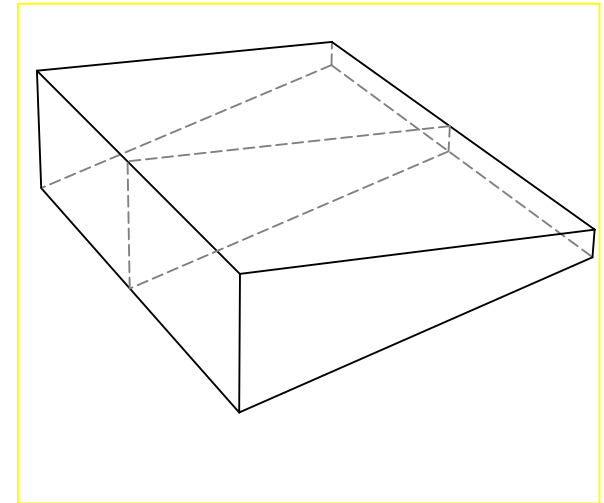
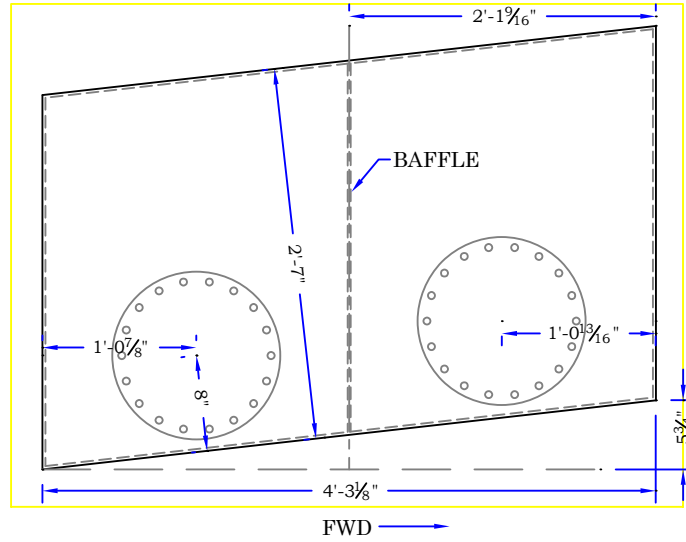
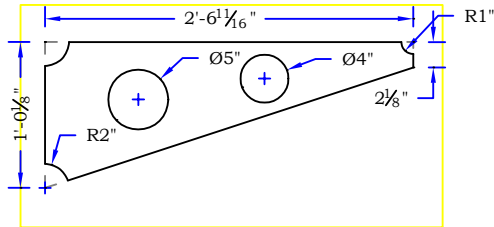

**AFT END**

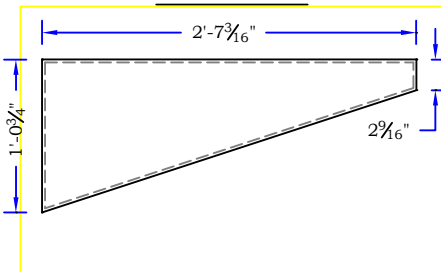

**SIDE VIEW**

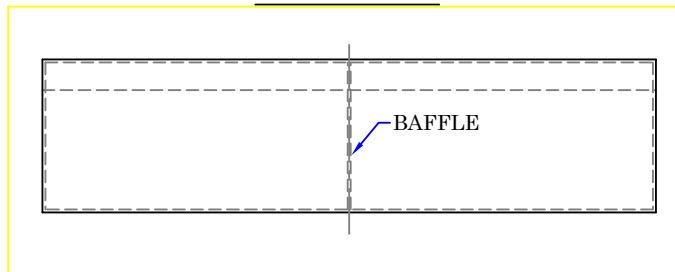

**FWD END**

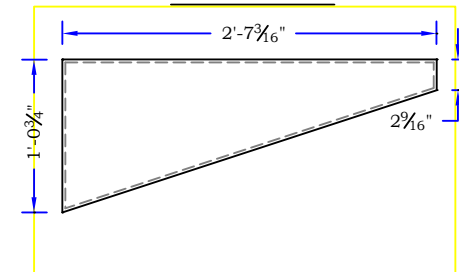

- NOTES: 1. DIMENSIONS ARE TO OUTSIDE OF TANK  
 2. FITTING LOCATIONS PER: BILLY K.  
 3. TANK MATERIAL: 5086-H116 .250" ALUMINUM PLATE

**LM** LYMAN-MORSE BOATBUILDING CO., INC.  
 82 WATER STREET  
 THOMASTON, ME 04861  
 TEL: 207-354-6904  
 FAX: 207-354-8176  
 www.lymanmorse.com

**FAY 54**

TITLE			
45 Gal. Fuel Tank (Port Aft)			
FOR			
Russ Irwin & Fay Mark			
DRAWN BY	DATE	CHECKED BY	DATE
AJC	12/18/06		
SCALE	3/4" = 1'-0"	FILE	LM Tankage Dwg. REV 0